

LUXCRETE PAVEMENT LIGHTS AND SMOKE OUTLET PANELS

Pavement lights and smoke outlet panels can either be supplied precast or cast on site by skilled Luxcrete personnel. Pre-casting usually speeds up site installation and allows work to continue even during very cold weather. In situ casting enables larger areas to be formed and is more suitable for accommodating site falls and levels. However, careful consideration must be given to the size and shape of all panels to minimise the possibility of shrinkage. Our Technical Department is available to provide further advice. A selection of typical joint and edge details appear on Sheet No. 1a, but variations are of course possible. Glazed pavement lights have 100 x 100mm moulded glass lenses. Panels can be supplied with galvanised cast iron ventilators in space of lenses, with drip trays under if required.

Where light transmission is unnecessary, plain surface panels with concrete infill's can be supplied for horizontal or vertical smoke outlets such as those for ducting or shafts from lower basements. The top concrete surface of both glazed and infill panels have a trowelled finish incorporating carborundum grains.

Regulations stipulate that smoke outlet panels must be identified; Luxcrete non-ferrous metal identification plates must be cast into the panel surface and brass demarcation strips can also be supplied if required.

A construction has been specially designed for use where the surface finish of the smoke outlet panel must match the surrounding area (see details with prefix SG). This construction supports the General Contractor's finishes. Fire Brigade approval must be obtained whenever this construction is to be used. Luxcrete can provide a test panel to permit the General Contractor to apply the finishes to allow the Fire Brigade to witness a physical test.

Luxcrete constructions other than the solid-grid type (S.G.) can be designed to be removed to provide access to machinery etc.

Luxcrete also supply and fix goods access flaps and fire escape hatches and ladders for compliance with fire safety regulations.

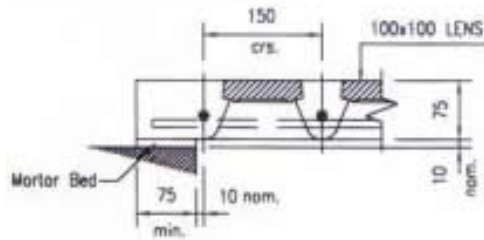
P150/75 – PRECAST ONLY

5KN/M² – 1820mm Max. Clear Span
 20KN/M² – 940mm Max. Clear Span
 Self Weight = 132kg/m²

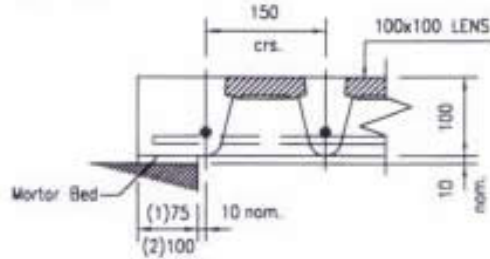
P150/100

5KN/M² – 2570mm Max. Clear Span
 (1) 20KN/M² – 1370mm Max. Clear Span
 (2) 75KN Ult – 1500mm Max. Clear Span
 Self Weight = 171kg/m²

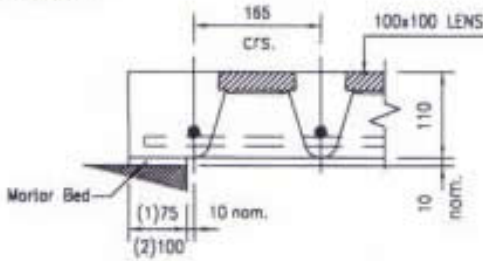
P165/110

5KN/M² – 2950mm Max. Clear Span
 (1) 20KN/M² – 1650mm Max. Clear Span
 (2) 75KN Ult – 1500mm Max. Clear Span
 Self Weight = 185kg/m²

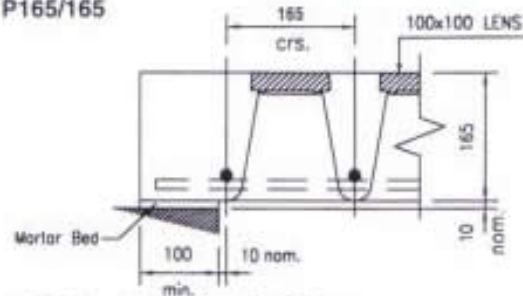
P165/165

5KN/M² – 4440mm Max. Clear Span
 20KN/M² – 2560mm Max. Clear Span
 75KN Ult – 2400mm Max. Clear Span
 Self Weight = 283kg/m²

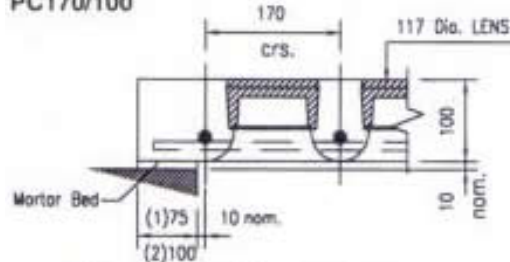
PC170/100

5KN/M² – 2410mm Max. Clear Span
 (1) 20KN/M² – 1320mm Max. Clear Span
 (2) 75KN Ult – 1500mm Max. Clear Span
 Self Weight = 190kg/m²

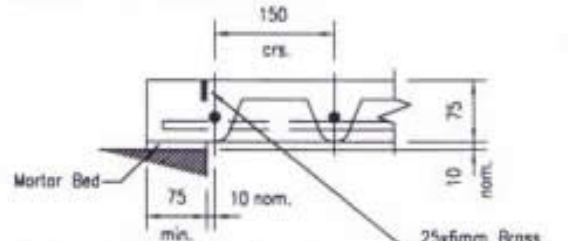
S150/75 – PRECAST ONLY

5KN/M² – 2055mm Max. Clear Span
 20KN/M² – 1240mm Max. Clear Span
 Self Weight = 132kg/m²

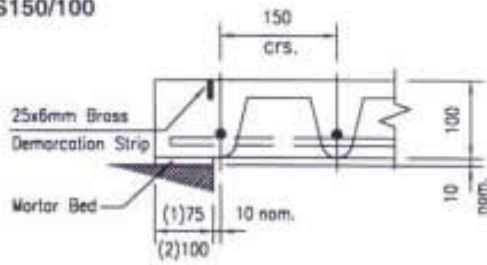
S150/100

5KN/M² – 2740mm Max. Clear Span
 (1) 20KN/M² – 1820mm Max. Clear Span
 (2) 75KN Ult – 1500mm Max. Clear Span
 Self Weight = 185kg/m²

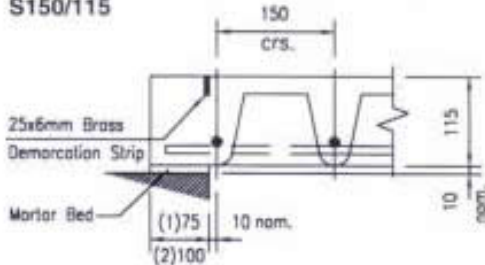
S150/115

5KN/M² – 3050mm Max. Clear Span
 (1) 20KN/M² – 1950mm Max. Clear Span
 (2) 75KN Ult – 1500mm Max. Clear Span
 Self Weight = 190kg/m²

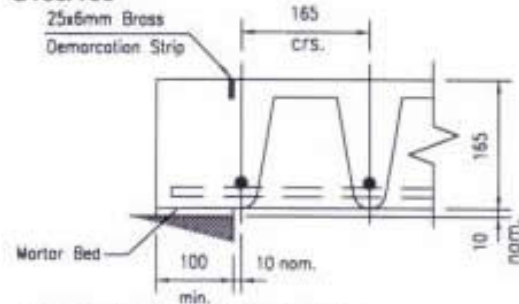
S165/165

5KN/M² – 4440mm Max. Clear Span
 20KN/M² – 3050mm Max. Clear Span
 75KN Ult – 2400mm Max. Clear Span
 Self Weight = 283kg/m²

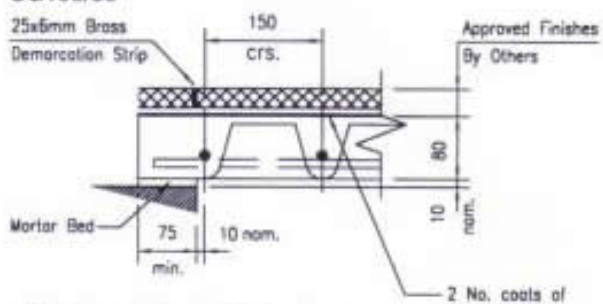
SG150/80

5KN/M² – 2130mm Max. Clear Span
 20KN/M² – 1320mm Max. Clear Span
 Self Weight = 127kg/m²

2 No. coats of
R.I.W. to top
surface of panel
by others

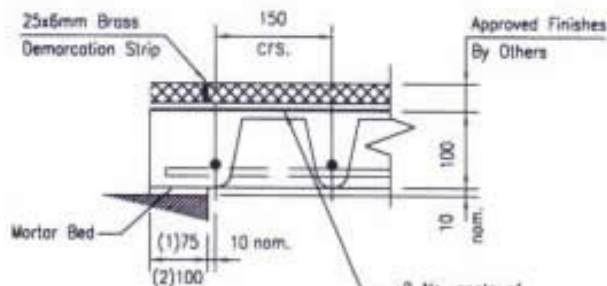
SG150/100

5KN/M² – 2740mm Max. Clear Span
 (1) 20KN/M² – 1750mm Max. Clear Span
 (2) 75KN Ult – 1500mm Max. Clear Span
 Self Weight = 161kg/m²

2 No. coats of
R.I.W. to top
surface of panel
by others

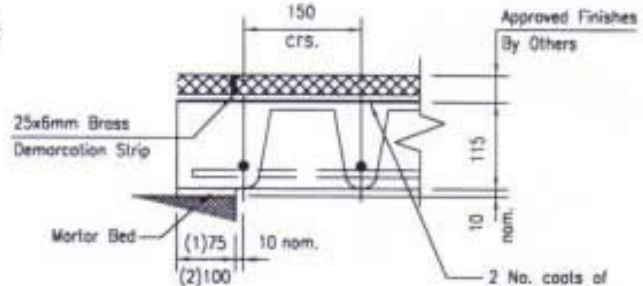
SG150/115

5KN/M² – 3050mm Max. Clear Span
 (1) 20KN/M² – 1950mm Max. Clear Span
 (2) 75KN Ult – 1500mm Max. Clear Span
 Self Weight = 190kg/m²

2 No. coats of
R.I.W. to top
surface of panel
by others